

## 2D OVERALL LAYOUT

### SCOPE:

#### OPEN AREA #1

[12] 2'x4'x53"H POWERED WORKSTATIONS W/

[1] BOX BOX FILE PEDESTAL /EA

[1] HALF HEIGHT SHELF /EA

#### OPEN AREA #2

[6] 21"x48"x53"H NON-POWERED WORKSTATIONS W/

[1] BOX BOX FILE PEDESTAL /EA

#### EXECUTIVE OFFICE #1 [MARK'S OFFICE]

[1] 7'x8'-6" L-SHAPE DESK W/

[1] BOX BOX FILE PEDESTAL

[1] FILE-FILE PEDESTAL

[1] 24"x42" HUTCH W/ GLAZED DOORS

[1] 24"Dx18"Lx84"H WARDROBE W/ GLAZED DOOR

[1] 24"x78"x29/72"H STORAGE CABINET COMBO

[1] 3 SEAT SOFA

[2] SINGLE LOUNGE CHAIRS

[1] 20"Dx40"Wx15"H COFFEE TABLE W/ GLASS TOP

#### PRIVATE OFFICES #1 to #5 & #8

[1] 5'-6"x6'-6" L-SHAPE DESK /EA WITH:

[1] BOX BOX FILE PEDESTAL /EA

[1] FILE FILE PEDESTAL /EA

[1] 2-DRAWER LATERAL FILE & BOOKCASE HUTCH/EA

#### PRIVATE OFFICES #6 & #7

[1] 5'-6"x8'-6" U-SHAPE DESK /EA WITH:

[1] BOX BOX FILE PEDESTAL /EA

[1] FILE FILE PEDESTAL /EA

[1] 2-DRAWER LATERAL FILE & BOOKCASE HUTCH /EA

[1] 24"x24" END TABLE [ONLY OFFICE #6]

[2] LOUNGE CHAIRS [ONLY OFFICE #6]

[1] 36"DIA MEETING TABLE [ONLY OFFICE #7]

#### PRIVATE OFFICES #9 & #10

[1] 5'-6"x6'-6" L-SHAPE DESK /EA WITH:

[1] BOX BOX FILE PEDESTAL /EA

[1] FILE FILE PEDESTAL /EA

#### CONFERENCE ROOM

[1] 4'x8' BOAT SHAPED POWERED CONFERENCE TABLE

[1] 2'x6'x29.5"H STORAGE CREDENZA

#### TRAINING ROOM

[1] 2'x5' TRAINING TABLE

[3] 2'x6' TRAINING TABLES

#### BREAK ROOM

[2] 3'x3' TABLES

### SEATING

[18] TASK CHAIRS

[1] EXECUTIVE TASK CHAIR

[2] EXECUTIVE GUEST CHAIRS

[10] MANAGER'S CHAIRS

[24] GUEST CHAIRS

[8] CONFERENCE CHAIRS

[11] TRAINING ROOM CHAIRS

[5] STACK CHAIRS FOR BREAK ROOM

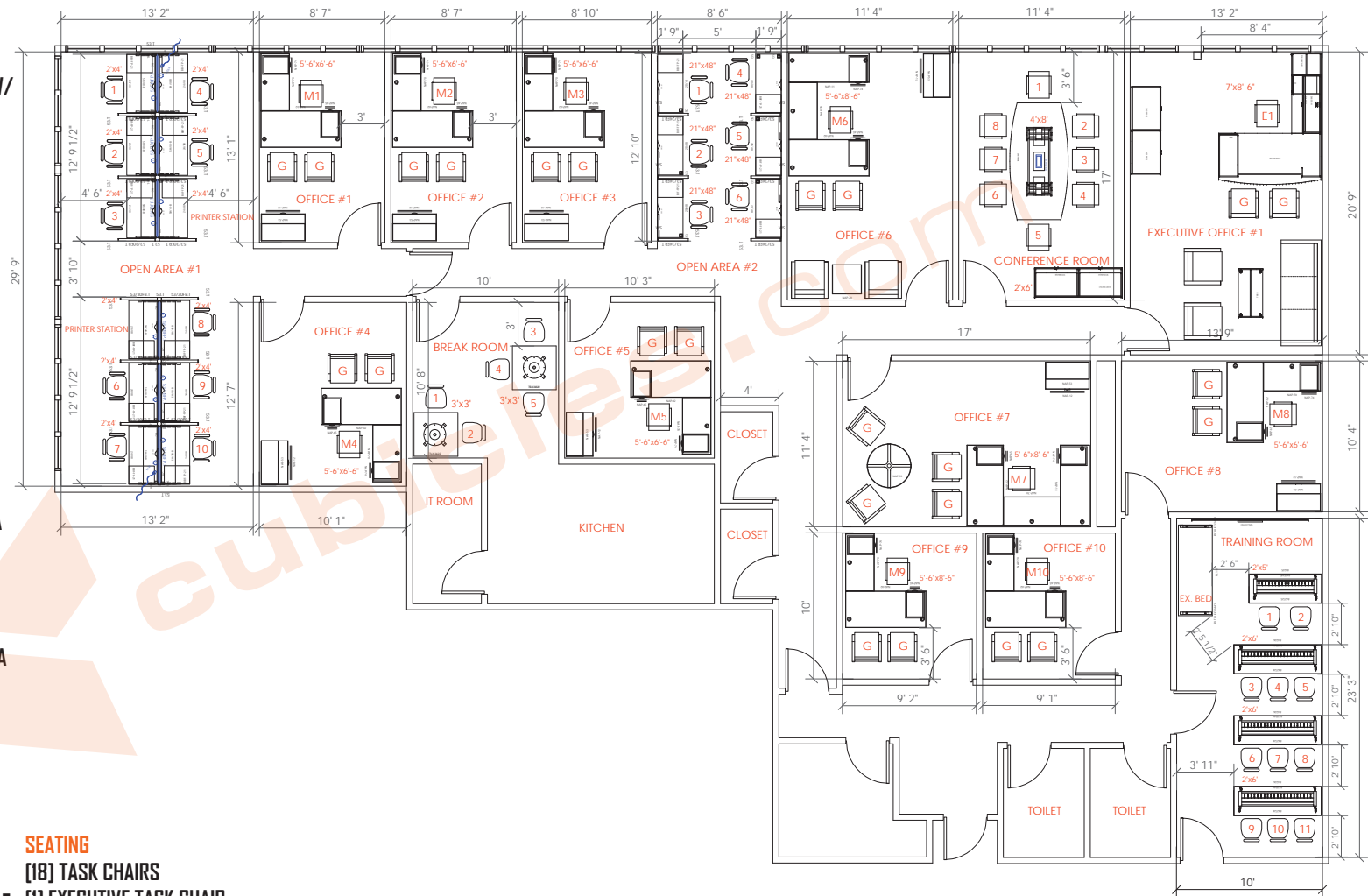

## 2D NEW OVERALL LAYOUT

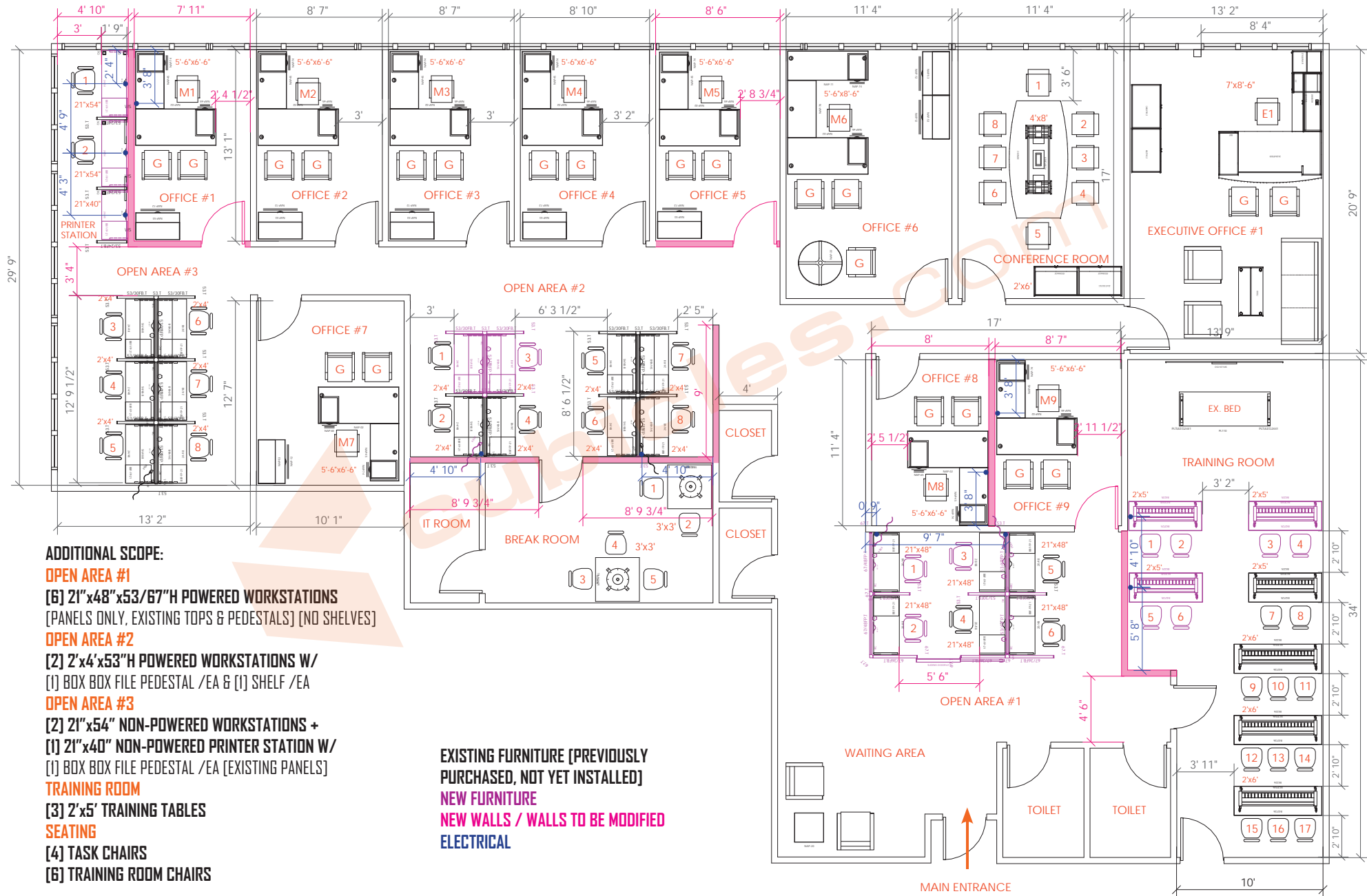

# 2D & 3D BLOW-UP LAYOUTS | CONFERENCE & TRAINING | BREAK ROOM

## GLOBAL ZIRA & TRAINING COLLECTIONS

- CONFERENCE ROOM**  
 (1) 4'x8' BOAT SHAPED POWERED  
 CONFERENCE TABLE  
 (1) 2'x6'x29.5"H STORAGE  
 CRENDENZA  
**TRAINING ROOM**  
 (1) 2'x5' TRAINING TABLE  
 (3) 2'x6' TRAINING TABLES  
**BREAK ROOM**  
 (2) 3'x3' TABLES



POWER UNIT  
 2 Power Outlets  
 2 USB Ports  
 1 Data Outlet  
 1 Phone Outlet  
 1 USB Data Port

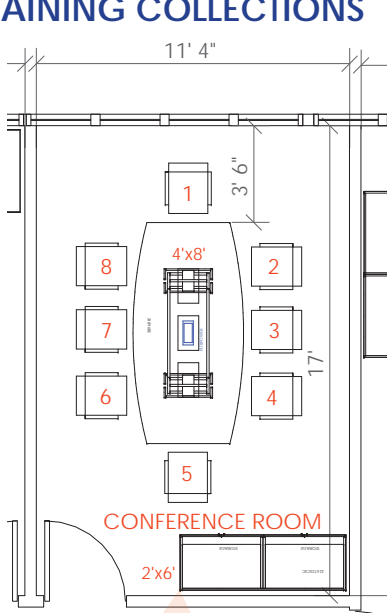

LAMINATE:  
ABSOLUTE ACAJOU

FLARED SILVER  
HANDLE

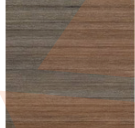

STORAGE  
CRENDENZA

TOP: SHADOW  
RIDGE

BASE: BLACK

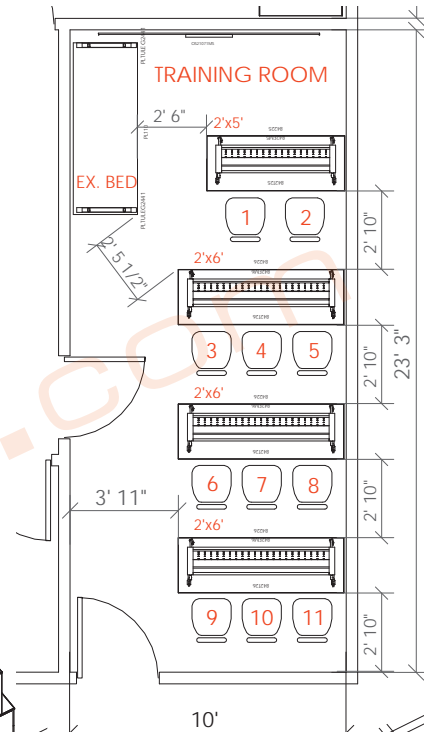
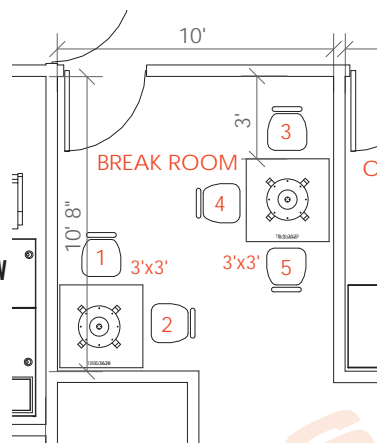

TOP: URBAN WALNUT



BASE: BLACK



TRAINING TABLE

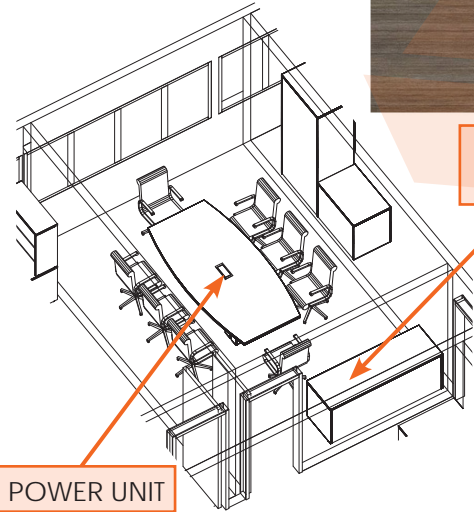

POWER UNIT

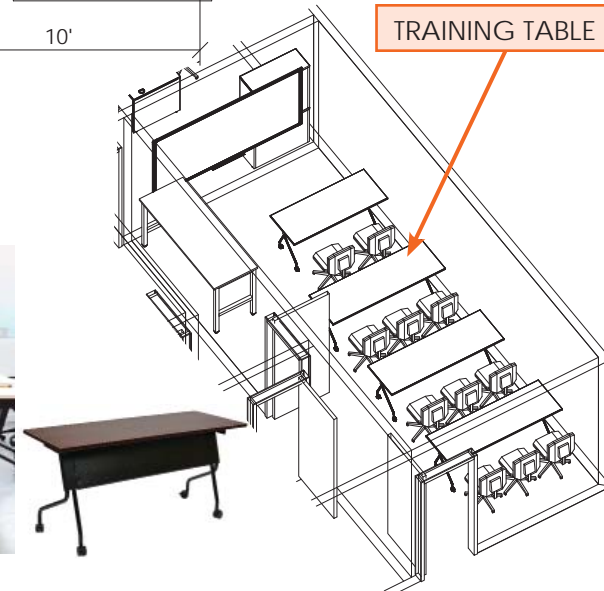

IMAGES FOR REFERENCE ONLY, NOT SPECIFIC TO THE PROJECT.



# 2D & 3D BLOW-UP LAYOUTS | OPEN AREAS #1, #2 & #3

## O2 CORPORATE OFFICE FURNITURE | THIN BASE | GRADE 1 | POWERED & NON-POWERED

### ADDITIONAL SCOPE:

#### OPEN AREA #1

[6] 21"x48"x53/67"H POWERED WORKSTATIONS

[PANELS ONLY, EXISTING TOPS & PEDESTALS] [NO SHELVES]

#### OPEN AREA #2

[2] 2'x4'x53"H POWERED WORKSTATIONS W/

[1] BOX BOX FILE PEDESTAL /EA & [1] SHELF /EA

#### OPEN AREA #3

[2] 21"x54" NON-POWERED WORKSTATIONS +

[1] 21"x40" NON-POWERED PRINTER STATION W/

[1] BOX BOX FILE PEDESTAL /EA [EXISTING PANELS]

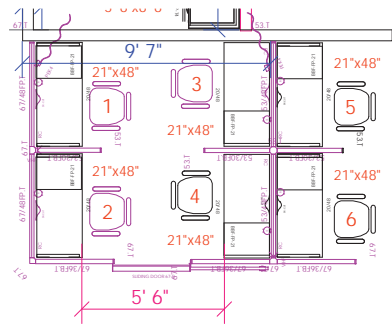

OPEN AREA #1

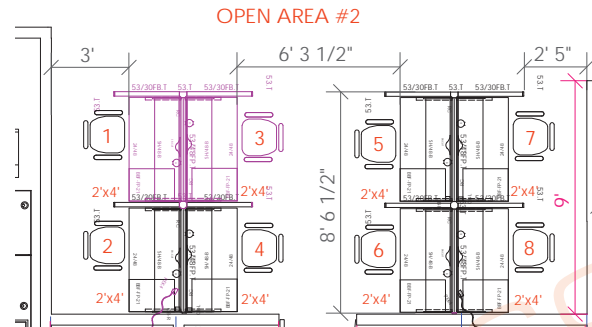

OPEN AREA #2

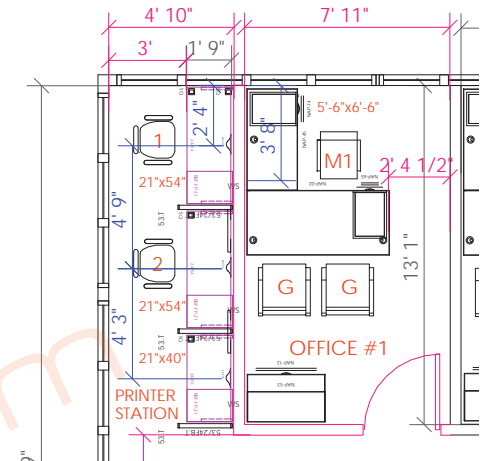

OPEN AREA #3

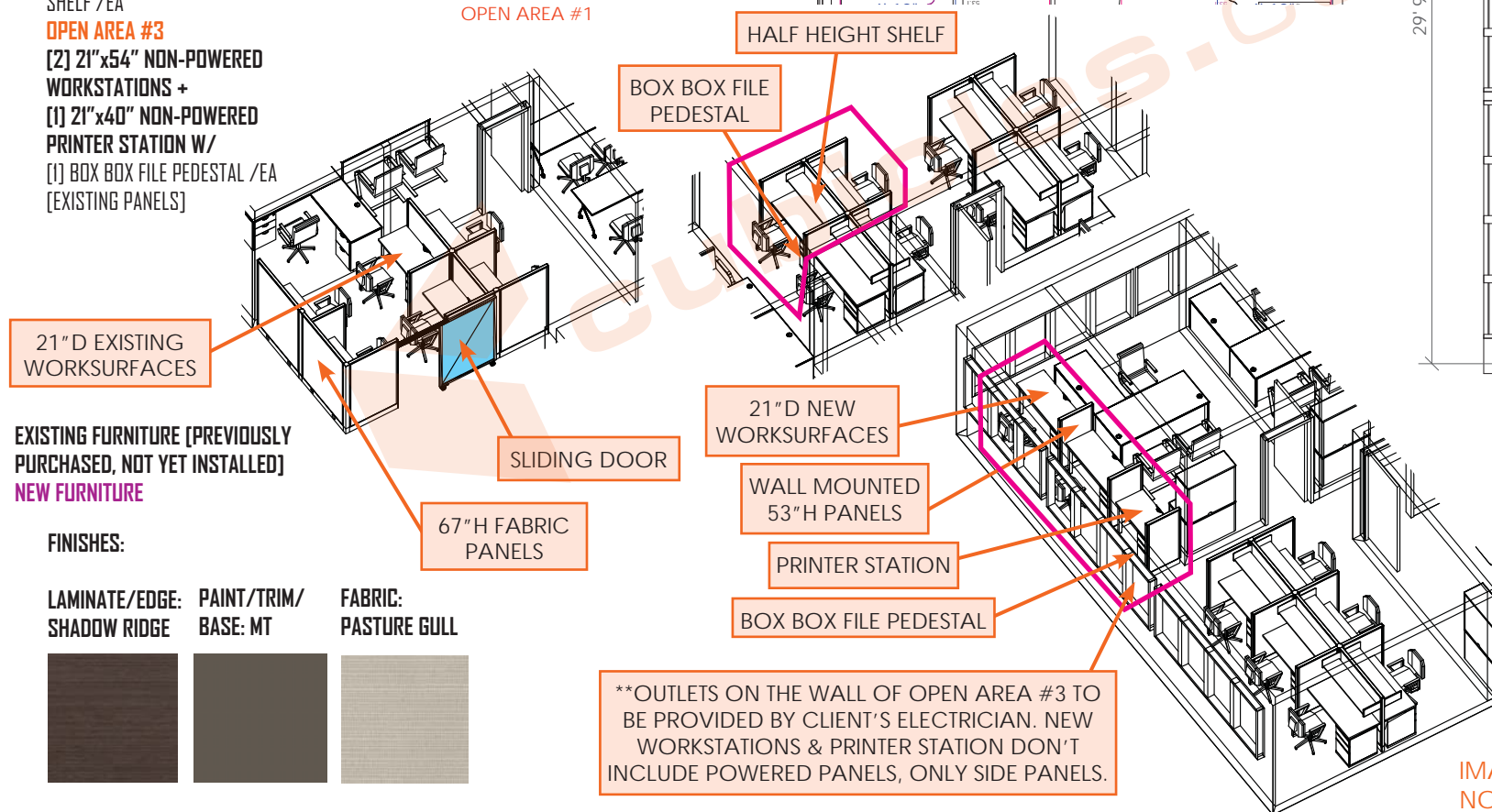

### FINISHES:

LAMINATE/EDGE:  
SHADOW RIDGE

PAINT/TRIM/  
BASE: MT

FABRIC:  
PASTURE GULL

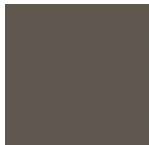

IMAGES FOR REFERENCE ONLY,  
NOT SPECIFIC TO THE PROJECT.

## 2D & 3D BLOW-UP LAYOUTS | BREAK ROOM TRAINING COLLECTION

## | SEATING | OFFICES TO GO & OFFICE STAR SEATING

**ADDITIONAL SCOPE:**  
**TRAINING ROOM**  
 [3] 2'x5' TRAINING TABLES  
**SEATING**  
 [4] TASK CHAIRS  
 [6] TRAINING ROOM CHAIRS

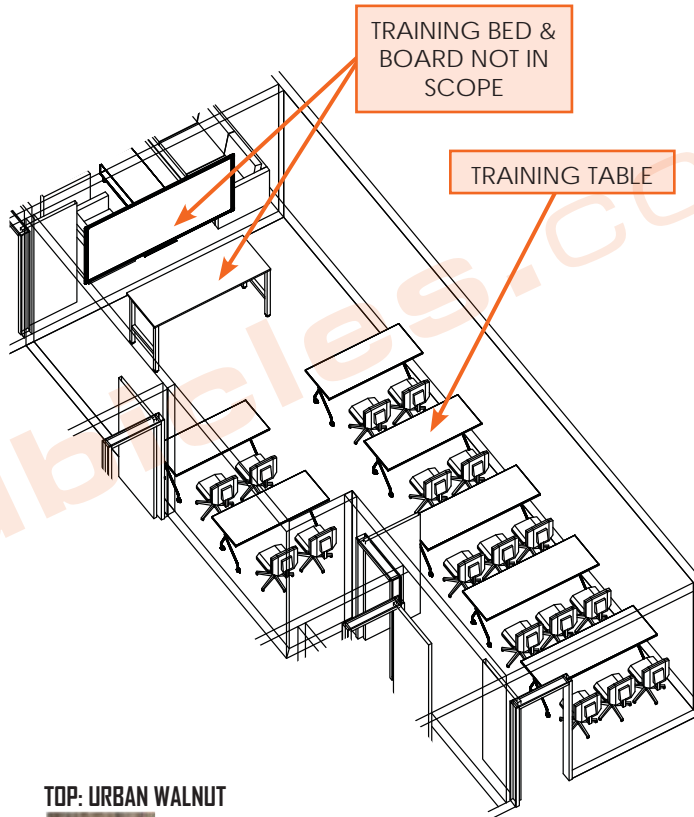
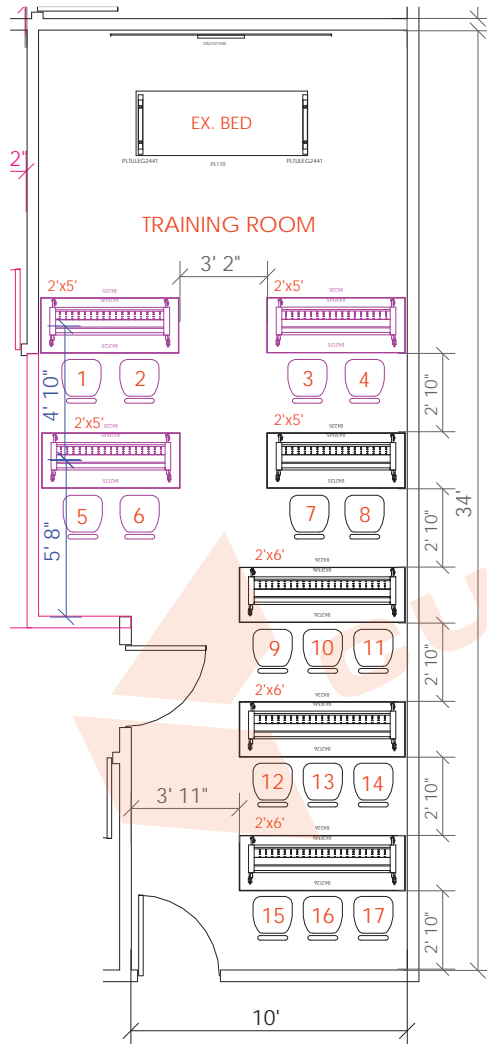

TOP: URBAN WALNUT



BASE: BLACK



**WORKSTATIONS**  
 QTY. [4]



**TRAINING ROOM**  
 QTY. [6]



**EXISTING FURNITURE [PREVIOUSLY  
 PURCHASED, NOT YET INSTALLED]**  
**NEW FURNITURE**

IMAGES FOR REFERENCE ONLY, NOT SPECIFIC TO THE PROJECT.